



# Product information

Series AMI

## Bell button module

### AMI1090x

- AMI10901 1 button
- AMI10902 2 buttons
- AMI10903 3 buttons
- AMI10904 4 buttons



#### **Note on the validity of this product information**

This product information states specific information on the modules.

It is only valid in combination with the enclosed product information *Modules of the series AMI in front-door stations.*

## Table of contents

|  |           |
|--|-----------|
| Note on the validity of this product information.....                  | 1         |
| <b>Scope of delivery</b> .....   | <b>3</b>  |
| <b>Intended use</b> .....  | <b>3</b>  |
| <b>Short description</b> .....   | <b>3</b>  |
| <b>Technical data</b> .....  | <b>3</b>  |
| <b>Overview</b> .....  | <b>4</b>  |
| <b>Connect the lines</b> .....   | <b>4</b>  |
| Connect the module within the front-door station .....                 | 4         |
| ...in connection with a built-in door loudspeaker module AMI11100..... | 4         |
| ...in connection with a display module AMI1010x.....                   | 5         |
| <b>Configuration</b> .....   | <b>5</b>  |
| Pre-settings ex works .....  | 5         |
| Configuration options .....  | 5         |
| <b>Programme bell buttons</b> .....                                    | <b>6</b>  |
| Basic principle .....  | 6         |
| Manual programming of a bell button .....                              | 6         |
| Notes: .....   | 6         |
| Programming a second indoor station to a bell button .....             | 7         |
| Delete the programming.....  | 9         |
| <b>Label the nameplate</b> .....                                       | <b>10</b> |
| Open and close the module – the win:clip™ system .....                 | 10        |
| <b>Accessory</b> .....   | <b>11</b> |
| <b>Service</b> .....   | <b>12</b> |

## Scope of delivery

- 1 x bell button module AMI1090x
- 3 x spacer foil 0.5 mm
- 1 x connection cable with 4 pins
- 4 x mounting nut M4
- 1 x win:clip™ key
- 1 x nameplate foil
  - product information bell button module AMI1090x
  - product information Modules of the series AMI in front-door stations

## Intended use

- The bell button modules AMI1090x are modules for the front-door stations of the series AMI.
- They are suitable to carry name tags and as push button (e.g. to trigger door calls).
- They can be used only in combination with a display module AMI1010x, a built-in door loudspeaker module AMI11100 or a codelock module AMI11200 (TCS:BUS® connection necessary)!

## Short description

- bell button modules in the variations with 1 to 4 buttons
- connection via the connection cable with 4 pins of the built-in door loudspeaker module or at the display module
- further connection for the outgoing connection to the next module
- white LED backlight
- indication of programming modes and device errors by different blink modes
- per bell button, the functions light, 2 x door call or control function can be programmed
- nameplate glass can be opened with the win:clip™ system and be removed forwards

## Technical data

|                                |   |
|--------------------------------|---|
| supply voltage                 | +24 V ± 8 % (power supply and control unit) |
| housing                        | aluminium, anodised                         |
| nameplate                      | acrylic glass                               |
| H x W x D                      | 105 x 105 x 20 mm                           |
| weight                         | 185 g                                       |
| acceptable ambient temperature | -25 °C to +55 °C                            |
| input current standby          | I(a) = 0.3 mA, I(P) = 4.5 mA                |

3-wire technique necessary!

## Overview

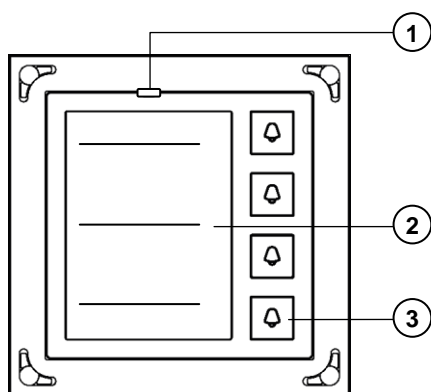

1 opening for win:clip™key

2 nameplate glass  
with backlight

3 bell button

4 connections  
built-in door loudspeaker-  
module AMI11100 or a  
module with connection  
cable with 4 pins (e.g. code-  
lock module AMI11200)

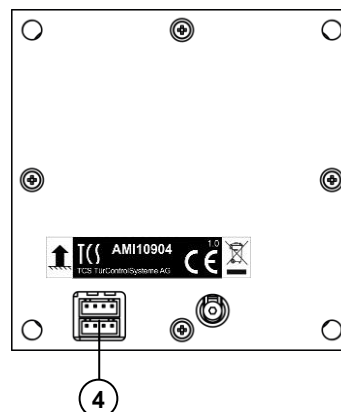

## Connect the lines

### Connect the module within the front-door station

After the installation in the front panel, the modules themselves have to be wired. The bell button module can be connected to a built-in door loudspeaker module AMI11100 or to a module with connection cable with 4 pins.

### ...in connection with a built-in door loudspeaker module AMI11100

Built-in door loudspeaker module

- Remove the cover of the service opening and the terminal cover.
- Guide the cable upwards from the terminals and push it slightly under the module housing. Plug the connection cable with 4 pins on the service socket in the service opening.
- Close the service opening and the terminal cover.

#### Note on commissioning:

The AS addresses of the bell button modules and the built-in door loudspeaker module resp. the display module must be identical to establish a connection:

- Set all AS addresses to the same value and block the addresses.

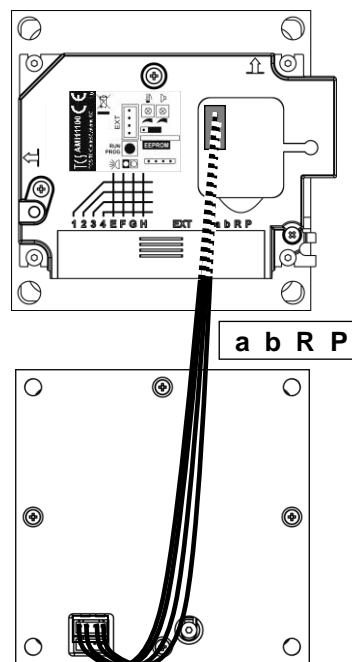

...in connection with a display module AMI1010x

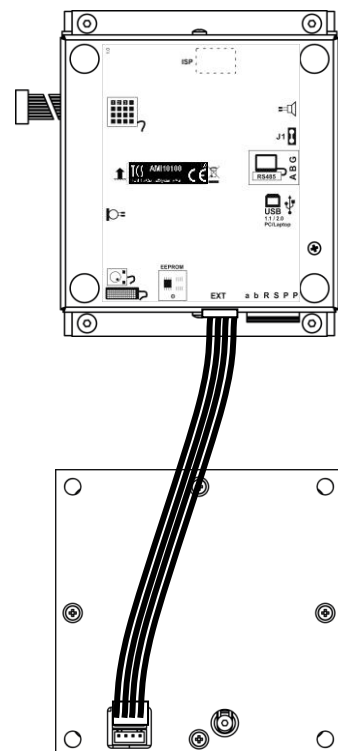

## Configuration

### Factory settings

|                   |                  |
|-------------------|------------------|
| button assignment | switching lights |
| AS address        | 0                |
| backlight         | ON               |
| programming lock  | OFF              |

### Configuration options

|   | manual | TCSK-01 | config <sup>TM</sup><br>as of 1.7.1 |
|---|--------|---------|-------------------------------------|
| delete a bell button ( = assign a bell button with light switch function) | x      | x       | x                                   |
| assign a bell button with door call to serial number 1                    | x      | x       | x                                   |
| assign a bell button with door call to serial number 2                    | x      | x       | x                                   |
| adjust the allocated AS address   | -      | x       | x                                   |
| set and reset the programming lock  | -      | x       | x                                   |
| send a control function   | -      | -       | x                                   |

## Programme bell buttons

### Basic principle

- All devices at the TCS:BUS® have a unique serial number.
- When programming a bell button, the serial number is allocated to an indoor station and is stored in the EEPROM of the front-door station. Per bell button 1 or 2 indoor stations (serial numbers) can be allocated and called.
- If no serial number is allocated to a bell button (delivery state: deleted), lights can be switched by pressing this button.











### Manual programming of a bell button

Ensure that the indoor station at the TCS:BUS® is connected and the mains voltage is switched on (the LED at the power supply and control unit is on).

#### Notes:

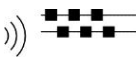
- Before an already programmed bell button can be programmed anew, the programming has to be deleted.
- The AS addresses of the bell button modules and of the built-in door loudspeaker module resp. display module must be identical to establish a connection: Adjust the AS addresses to the same value and block the addresses.
- The AS addresses of the bell button module AMI1090x can only be adjusted with the configuration software configo™ or the Service Device TCSK-01. Protocol digit when setting via TCSK-01: \*76 # SNr. # AS #.

### Legend

|                      |   |  |   |
|----------------------|---|--|---|
| press button shortly |  | negative acknowledgement (name plate blinks fast 5x)                   |  |
| press button until   |  | positive acknowledgement (name plate is on shortly, then blinks again) |  |
| release button       |  | Progsper tone  |  |
| ring tone            |  | repeat   |  |
| period (e.g. 6 sec)  |  | continue   |  |

### 1 Initiate Switch off the programming mode of the system

power supply and control unit

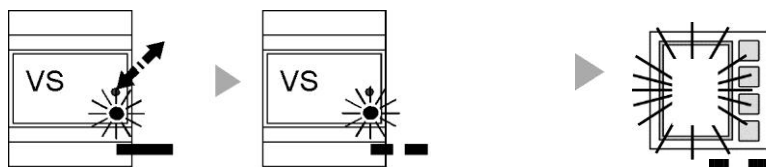

Shortly press the RUN/PROG button LED blinks

Nameplate of the bell button module blinks. Programming mode of the system is switched on.

2a

## Via voice connection

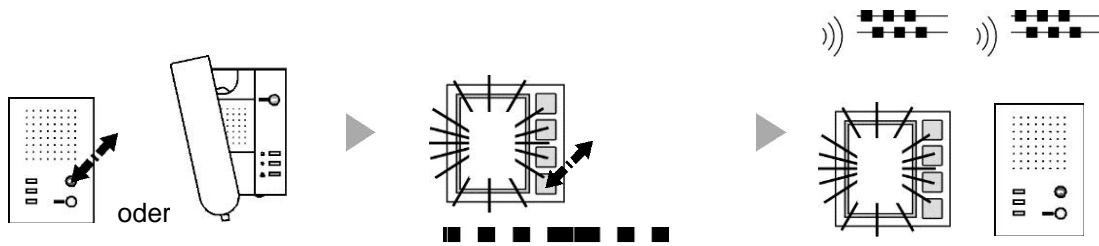

Establish voice connection to the front-door station

Shortly press the button, positive acknowledgement

... a ring tone sounds at the front-door and indoor station <sup>1)</sup>

2b

## alternatively: via floor push button (indoor station is not available)

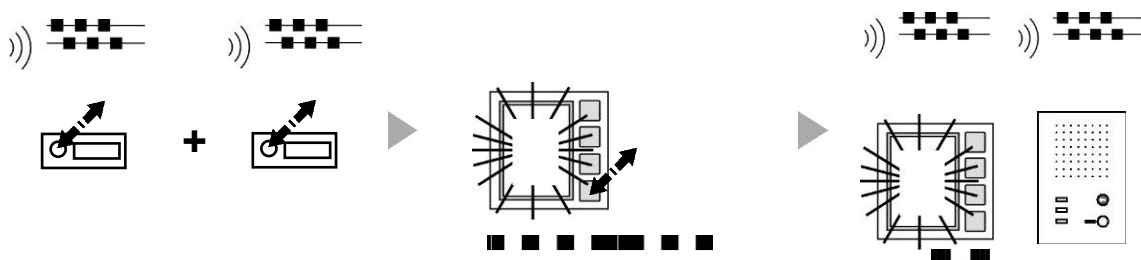

Shortly press the floor push button two times, every time a ring tone sounds

Shortly press the button, positive acknowledgement

... a ring tone sounds at the front-door station and at the indoor station <sup>1)</sup>



Repeat the steps until all bell buttons are programmed.

3

## End

Power supply and control unit



Shortly press the:  
RUN/PROG push button LED is on

Nameplate of the bell button module ON (or OFF).  
Programming mode of the system is switched off

*1) If there is no response, the programming lock of the bell button module is activated. The programming lock can only be deactivated with a Service Device TCSK-01 or the configuration software configo™.*

### Programming a second indoor station to a bell button

If two indoor stations are to be called by pressing one bell button, the serial number of the second indoor station can be allocated additionally to this bell button.

#### Note:

A repeated programming of an already programmed bell button changes only the second serial number.

**1 Initiate** Switch on the programming mode of the system

Power supply and control unit

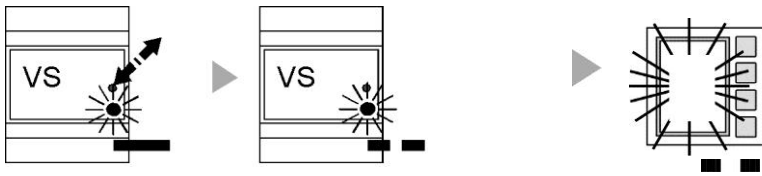

Shortly press the RUN/PROG push button LED blinks

Namesplate of the bell button module blinks. Programming mode of the system is switched on

**2a Via voice connection**

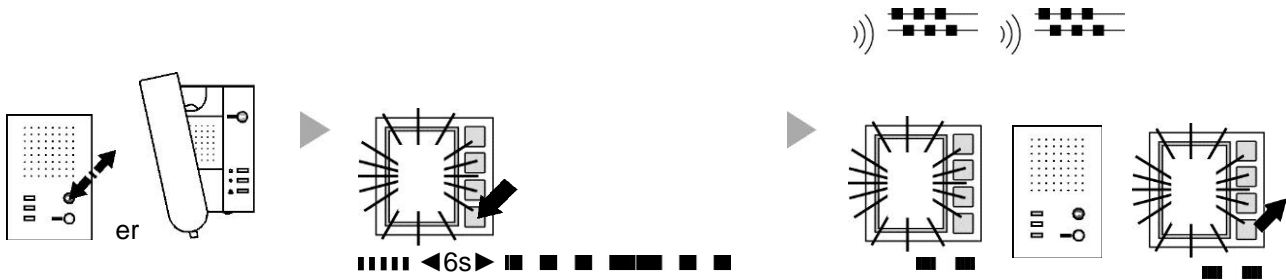

Establish voice connection to the front-door station

Press button until the negative acknowledgement and positive acknowledgement

... and a ring tone at the front-door and indoor station sound<sup>1)</sup> Release

**2b alternatively: Via floor push button** (indoor station is not available)

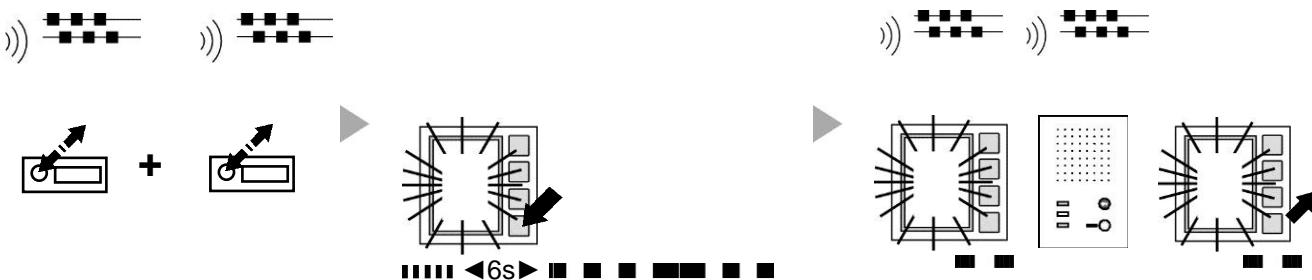

Press the floor push button two times, every time a ring tone sounds

Press the button until a negative acknowledgement and positive acknowledgement

... and a ring tone at the front-door and indoor station sound<sup>1)</sup> Release

Repeat the steps until all bell buttons are programmed

**3 End**

Power supply and control unit



Shortly press the RUN/PROG push button LED is on

Namesplate of the bell button module ON (or OFF). Programming mode of the system is switched off.

1) If there sounds a Progsper tone instead, a programming lock at the front-door station is activated. The programming lock can only be deactivated with a Service Device TCSK-01 or the configuration software config<sup>TM</sup>.



## Delete the programming

Before an already programmed bell button can be programmed anew, the programming must be deleted.

|  |                        |   |
|--|------------------------|---|
| <b>1</b>   | <b>Initiate</b>        | Switch on the programming mode <u>of the system</u>   |
|  |                        |   |
| Shortly press the RUN/PROG push button    LED blinks                                     |                        | Nameplate of the bell button module blinks. Programming mode <u>of the system</u> is switched on        |
| <b>2</b>   | <b>Delete a button</b> |   |
|  |                        |   |
| Press the button until a negative and positive acknowledgement tone sounds <sup>1)</sup> |                        | Release   |
| <b>3</b>   | <b>End</b>             |   |
|  |                        |   |
| Shortly press the RUN/PROG push button    LED is on                                      |                        | Nameplate of the bell button module ON (or OFF). Programming mode <u>of the system</u> is switched off. |

1) If there sounds an Progsper tone instead, the programming lock of the front-door station is activated. The programming lock can only be deactivated with the Service Device TCSK-01 or the configuration software configo™.

## Label the nameplate

Please find the templates AMI1090x under [www.tcs-ami.de](http://www.tcs-ami.de) > Downloads > Beschriftungsvorlagen.

1. Enter the required names in the template.
2. Print the nameplate with a **laser printer** on the special foil (included in the delivery) and cut it to size.
3. Push the cutted tag from the side into the pocket of the nameplate glass.

\* You can order the foil directly at TCS:  
Polyester foil which can be labeled for nameplates DIN A4.

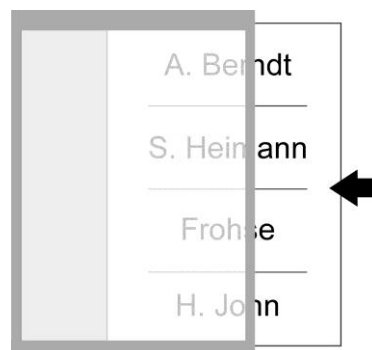

## Open and close the module – the win:clip™ system

The device is equipped with the win:clip™ system, thus opening and closing can be realised without any screws.

### Open the module

1. Push the enclosed win:clip™ key into the small opening.  
Press the key into the opening until stop and keep it in this position.
2. Push the nameplate glass slightly upwards until it jumps out.
3. Remove the glass.
4. Remove the win:clip™ key.

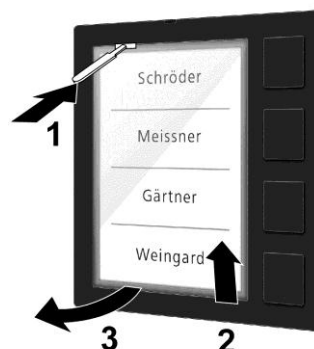

### Close the module

1. Push the enclosed win:clip™ key into the small opening.  
Press the key into the opening until stop and keep it in this position.
2. Push the nameplate glass from above under the front panel.
3. Press the nameplate glass onto the device and push it slightly downwards until it snaps in.
4. Remove the win:clip™ key.

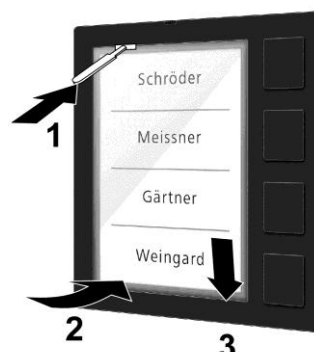

**Accessory**

| <b>Short text</b>               | <b>Article number</b> |
|---------------------------------|-----------------------|
| Maintenance package             | FBI1210-0             |
| Laser film foil matt, A5 format | 0031123               |

---

## Service

Send your questions and inquiries to

**hotline@tcsag.de**

### Headquarters

TCS TürControlSysteme AG, Geschwister-Scholl-Str. 7, D-39307 Genthin  
Phone: +49 (0) 39 33 / 87 99 10, Fax: +49 (0) 39 33 / 87 99 11, Mail: [info@tcsag.de](mailto:info@tcsag.de), [www.tcsag.de](http://www.tcsag.de)